

# Installation Instructions

## **Versatile Shower Threshold Seal**

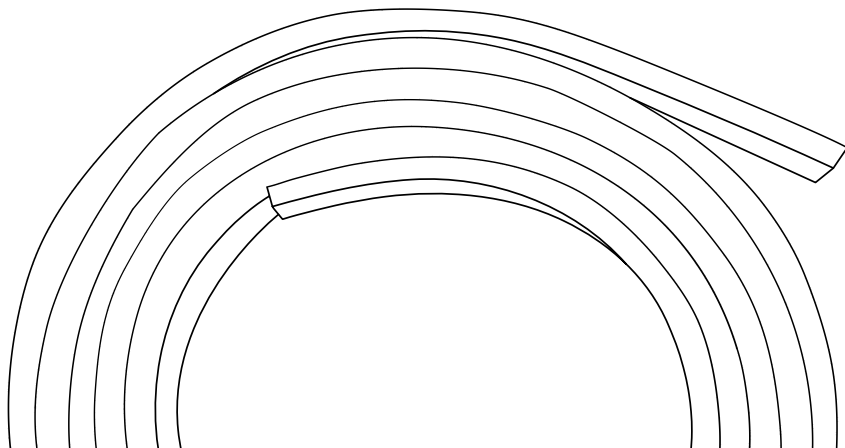

# Before you Start

**Your Versatile Threshold Seal is designed to be used in situations where water is escaping the open edge of a showering area under normal surface flow pressure.**

Its unique profile section design and its specially formulated soft PVC crystal material permits it to be cut and or curved to form a barrier in a wide variety of situations and shapes to limit spillage.

Suggested applications are:

- Wetroom entry points either tiled floors or lino surfaces.
- Shower tray slab edges, both smooth and textured finishes.
- Low profile and high wall shower tray edges of almost any shape fitted with a walk-in or frameless type enclosure.



Technical Service Line: 0845 505 2211 / 01684 293311 Open Mon–Fri 9am–5pm



## Important

Before you start please read these instructions fully in conjunction with any other installation instructions supplied with your bathroom. For example a wetroom tanking system, shower tray and or shower enclosure.



Please check that you have sufficient length of threshold seal to fit the area required.



Please check that the intended area of application has a level or for best results a positive flow angle surface towards the waste outlet to enable return of the bulk of the water.



Please ensure the waste outlet and plumbing can cope with the rated output from your intended shower unit.



Please check that you have all the supplied parts listed below.

### Supplied parts

- 2m Versatile Threshold Seal
- IPA cleaning wipe

### Materials required (not supplied)

- Sharp hobby knife.
- Hairdryer or similar.
- Suitable heat protecting gloves.
- Suitable good quality clear neutral cure silicone adhesive and applicator.
- Suitable silicone cleaner.
- Tape measure.

# Installation

1

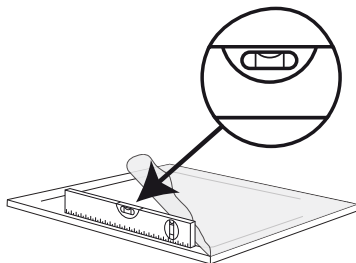

Please ensure that the intended area of application is completely free from protective films and clean and dry.

**FAILURE TO DO SO WILL RESULT IN THE ADHESION FAILING.**

The area **MUST** be checked with a level to ensure an adequate drainage angle.

2

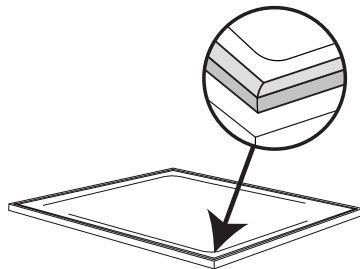

Measure out the length of threshold seal you require ensuring you will have a contact seal joint at each end. **DO NOT CUT THE SEAL UNTIL YOU ARE HAPPY IT IS THE CORRECT LENGTH.** If your intended area of application has a corner, this can be achieved either with a metred joint by cutting the threshold seal at 45 Degrees either side of the joint, or by forming a curve in the continuous length of the seal.

**Note! When using a knife, take care to avoid injury and damage to other items.**

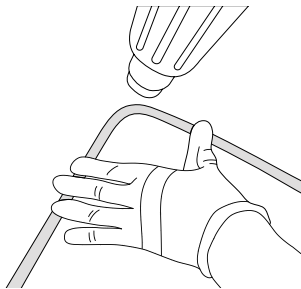
**3**

To form a curve or other shapes, place the seal on a heat-safe surface and gently warm the intend point of the curve with a hairdryer or similar, when the material becomes malleable simply bend it into the curve or other shape you require holding the hollowed side down.

**Note! When using a heat source, wear suitable protective gloves at all times.**

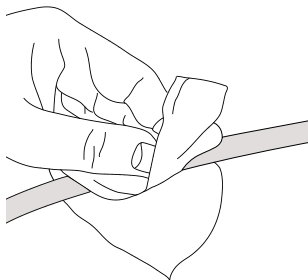
**4**

Once you have cut / shaped the seal to fit the area, dry fit to ensure correct size / fitting. **DO NOT PROCEED IF NOT SATISFIED.**

If you are happy with the fit of the seal, undertake a final clean of the area and seal using the IPA Cleaning Wipe supplied.

5

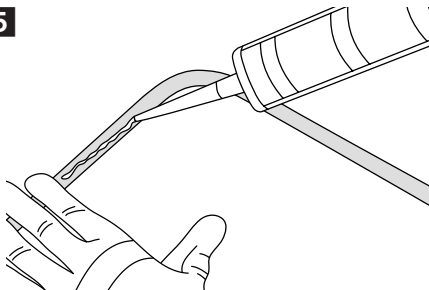

Carefully apply a minimum 7mm bead of neutral cure silicone adhesive to the centre of the hollowed side of the seal over its full length.

For best results we recommend a clear adhesive is used.

**Note! On some textured surfaces a thicker bead may be required.**

6

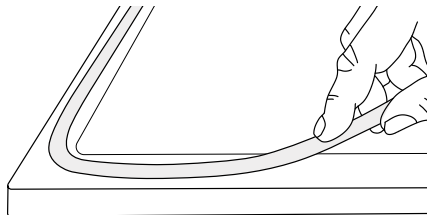

Carefully apply the seal with the adhesive attached to the intended area and gently press into place. The PVC crystal material is specially formulated to permit visibility through the seal to check that the adhesive has made sufficient contact with the surfaces, if gaps are visible, clean and repeat steps 3, 4, and 5.

Seal all joints with the silicone adhesive, once dry test with water to ensure no leakage.

# Troubleshooting

- Q** What is a suitable good quality clear neutral cure silicone adhesive?
- A** Contact your local supplier and ask for a suitable silicone for gluing PVC Cristal to the intended surface in a showering situation. Note! We strongly recommend that you test a small inconspicuous area with the intended adhesive and a small section of the seal.
- Q** Can I use a coloured silicone.
- A** Yes, but for best aesthetic results we recommend the use of a clear silicone.
- Q** The area I wish to apply the seal is bigger than 2m, can I use two kits and join them?
- A** Yes, simply seal the joint with the silicone adhesive.
- Q** How close to the shower unit can I place the seal?
- A** This is highly dependent on flow pressure, surface angle and waste unit / plumbing throughput. Therefore, for best results place the seal and the shower unit as far apart as possible.
- Q** The threshold seal doesn't overflow but leaks.
- A** Check that the adhesive has made good contact with the surfaces and if necessary reseal the edge of the seal with silicone.
- Q** Water overflows the threshold seal.
- A** Check that the overall area has a positive flow angle surface towards the waste outlet to enable return of water and ensure the waste outlet and plumbing can cope with the rated output from your shower unit.

Product supplied by the MX Group and/or its subsidiaries  
Technical Service Line: **0845 505 2211 / 01684 293311** Open Mon–Fri 9am–5pm

226CBK 30/9SD